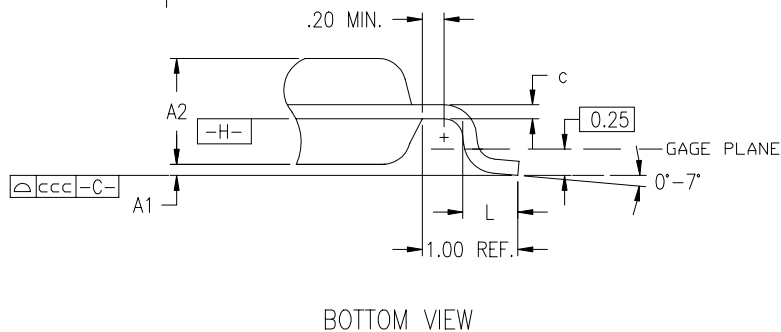

SYMBOL	MILLIMETERS		
	MIN.	NOM.	MAX.
A	$\sphericalangle$	$\sphericalangle$	1.60
A <sub>1</sub>	0.05	0.10	0.15
A <sub>2</sub>	1.35	1.40	1.45
D/E	26.00 BSC		
D <sub>1</sub> /E <sub>1</sub>	24.00 BSC		
b	0.17	0.22	0.27
c	0.09	$\sphericalangle$	0.20
e	0.50 BSC		
L	0.45	0.60	0.75
ccc	$\sphericalangle$	$\sphericalangle$	0.08
ddd	$\sphericalangle$	$\sphericalangle$	0.08

**NOTES:**

- ALL DIMENSIONS AND TOLERANCES CONFORM TO ANSI Y14.5M-1982.
  - DIMENSIONS "D<sub>1</sub>" AND "E<sub>1</sub>" DO NOT INCLUDE MOLD PROTRUSION. ALLOWABLE MOLD PROTRUSION SHALL NOT EXCEED 0.25mm ON EACH SIDE.
  - THE TOP OF PACKAGE MAYBE SMALLER THAN THE BOTTOM OF PACKAGE BY 0.10mm.
  - THIS OUTLINE CONFORMS TO JEDEC PUBLICATION 95 REGISTRATION MS-026.
- MARK ORIENTATION WITH RESPECT TO PIN-1 I.D.  
 IF 2 OR MORE CIRCLES EXIST ON TOP OF THE PACKAGE, USE THE SMALLEST CIRCLE AS PIN-1 I.D.

# 160-PIN TQFP (TQ160)